

2" CAN Display - SAE J1939



This product reads and processes SAE J1939 compliant CAN messages. The sunlight visible transfective LCD displays operating parameters and is complemented by three discrete alert LED's. An intuitive menu driven user interface accessed by three built-in tactile switches allows for easy display configurations.

- 32 X 128 dot matrix graphic LCD
- Displays active and stored faults (SAE J1939 DM1 & DM2)
- Single or Dual Line Display
- Environmentally sealed connector

Product Features

- Alarm output capable of switching up to 150 mA
- Built-in audible alarm (mutable)
- Bright, adjustable LED illumination

Specifications & Drawing

Mounting hardware torque:
6 lb-in
(0.68 N-m) max.

Mounting hole size:
Ø2.125±.015"
(Ø53.98±0.38mm)

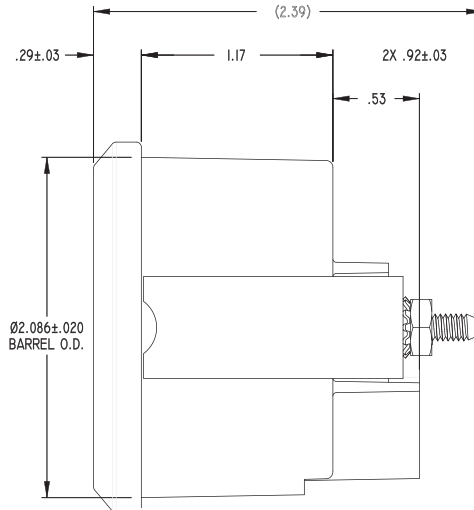
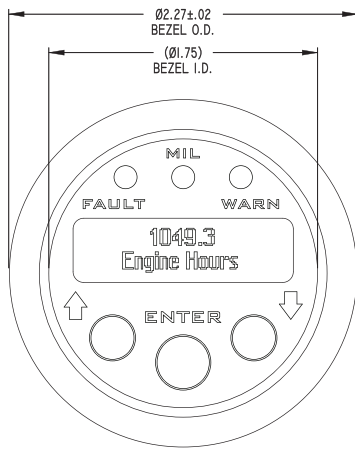

Master Node Configuration Connections*

Connector Wiring Table

Pin Number	Connection Name
1	Battery +
2	Ground
3	Serial Data
4	Switched Output
5	CAN-H
6	CAN-L

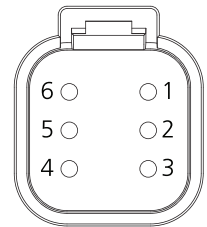

Refer to the appropriate Beede installation instruction sheet for complete installation requirements.

Environmental Specifications

- Shock (Non-operating):
50G, 9-13mS half-sine,
25 shocks in each of three orthogonal axes
- Vibration (Non-operating):
0.06" (1.5mm) double amplitude 10-80-10 Hz
2 hours in each of three orthogonal axes
- Temperature:
Operating, -20°F to 158°F (-30°C to 70°C)
Storage, -40°F to 185°F (-40°C to 85°C) 50% RH
- Humidity:
95% relative humidity @110°F (43°C) non-condensing
- Salt Spray:
Meets or exceeds ASTM 117, 48 hours

Electrical Specifications

- Reverse Polarity Protection:
Standard entire system
- Load Dump:
Meets SAE J1113, 3 positive 80V transients
one minute intervals
- Operating Voltage:
11-16VDC standard
- Over Voltage:
Withstands 18V continuously for one hour
- Output Signal Switching:
150 mA Max.
- LCD:
Transfective FSTN dot matrix
positive image mode standard
6:00 O'Clock viewing angle
LED illuminated. Color, white

Mechanical

- Bezel Material:
Stainless steel or aluminum
Finish, customer specified
- Case:
White thermoplastic copolymer
- Dial:
Textured finish polymer
Opaque characters & background